

The versatility of the set, makes it necessary in any laboratory in which the viability of a project is being studied.

It allows to light from the axis of the camera non reflectant and reflectant surfaces just adding a diffusor filter.

Fitting a reflectant module, it can become a powerful darkfield angle of light on the surface to inspectionate. Moreover, it can be included in systems in which the space is a problem because despite its reduced size its available surface is practically all its diameter.



LIGHTING TECHNIQUE

Lighting mode: Direct, Diffuse*, Darkfield*
 Light source: 30 LEDs high intensity
 Colour (nm): See table 1
 LED life: 100.000 hours

ELECTRICAL

Max. power supply: 24VDC (Continuous models)
 Max. consumption: 150mA
 Wire include: 1L00AA (See table 2)
 Wire terminal: Brown -> 24VDC
 Blue -> 0V (GND)

MECHANICAL

LxWxH: See external plane
 Mounting: 3 (M4) & 3 (M5 DIM913)
 Housing material: Black anodized aluminium
 Weight: 180 grs.

ENVIRONMENTAL

Max. Operating Humidity: 95% non-condensing
 Operating temp: 0..40°C
 Storage temp: 0..60°C

EXTERNAL PLANE

ALL UNITS IN MILLIMETRES

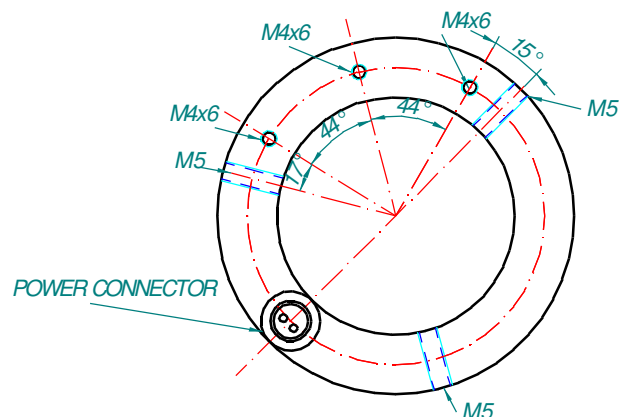
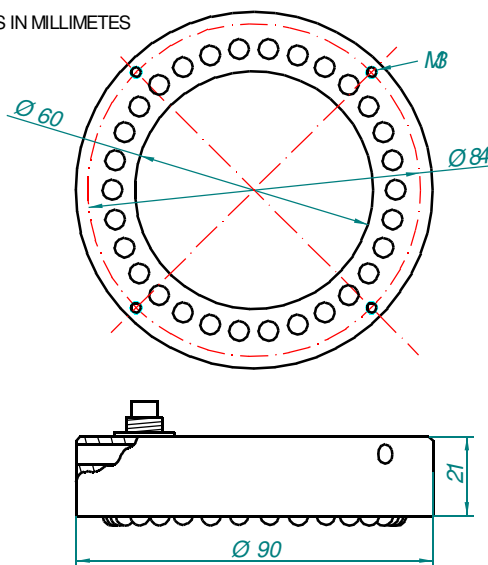

Note:

*Only with the optional accessory. See table 2.

MODELS

Table 1.

Light colour	Wavelength	Type	Reference
Red	660nm	Continuous	IL018AA
Red	660nm	Strobe	IL018AS
Near infrared	880nm	Continuous	IL018AN
Near infrared	880nm	Strobe	IL018AM
Infrared	940nm	Continuous	IL018AI
Infrared	940nm	Strobe	IL018AJ
White	-----	Continuous	IL018AB
White	-----	Strobe	IL018AC
UV	400nm	Continuous	IL018AU
UV	400nm	Strobe	IL018AW
Others	-----	????	Consult

COMPLEMENTS

Table 2.

Complement	Type	Reference
Wire 1.8 m	Wire	IL000AA
Wire 2.5 m	Wire	IL000AB
Wire 4.0 m	Wire	IL000AC
Strobe controller with 3 outputs	Strobe	IL004BB
MD-DKL curved reflector	Darkfield	IL022AA
MD-DKL curved reflector	Darkfield	IL022AB
MD-DIF filter	Diffusor	IL022AC

LIGHTING MODES

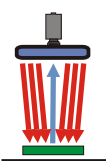

RADIAL DOWN LIGHT (STRONG LIGHT)

When the lighting comes from all the perimeter of the axis of the camera, it reduces shadows, softens textures and minimizes the influence of fissures, dust and faults that the object can have. The down light, due to the small opening of the beam, makes the system can be employed for further distances of the object and provides a great quantity of light. Ideal for the detection of marks of different colours, characters and detection of everything that supposes a change of colour in flat bright surfaces as in rough ones in high distances.

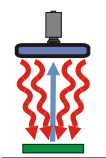

DIFFUSE RADIAL LIGHT (SOFT LIGHT) With filter IL022AC

When the lighting comes from all the perimeter of the axis of the camera, it reduces shadows, softens textures and minimizes the influence of fissures, dust and faults that the object can have when it gets the image. Ideal for the detection of marks of different colours, characters and the detection of everything that supposes a change of colour in flat bright surfaces as in rough ones.

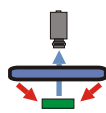

DARK FIELD LIGHT With reflectors IL022AA and IL022AB

Direct light of high intensity that falls on the object with a very little angle as regards the surface where it lies. In that way cracked or raised surfaces interfere on the trajectory of the light producing bright areas. The most typical applications for this technique are those to verify engravings, (laser, die), defects on the surface...